

Desulphuriser



CARTRIDGE FILTER BASED DESULPHURISATION UNIT

The desulphuriser removes sulphur contents in natural gas or LPG for usage in fuel cells or catalytic systems. Customised solutions for sulphur compounds like H₂S, COS, SO₂, THT and TBM are provided. The unit is constructed of two parts: the desulphuriser vessel and the filter cartridge that holds the adsorbent. Minimal pressure losses allow the usage of natural gas straight from a low-pressure grid.

DESULPHURISER VESSEL

- two-parts vessel with permanent installation inside gas path
- quick opening for adsorbent exchange
- connections (internal thread) from 1/2" to 1"
- material: stainless steel
- design pressure: 2 bar(a)

ADSORBENT

- adsorbents for wide application range and ambient temperatures up to 60 °C
- dimensioning according customer specification
- removal of THT, mercaptan (thiol), H₂S, COS, SO₂ to S_{tot} < 1 ppm
- lifetime depending on local conditions and sulphur loading

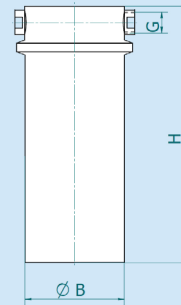

FILTER CARTRIDGE

- vertical flow direction
- gas-tight vessel screwing (for quick exchange)
- 50 µm outlet filter
- material: stainless steel

Types (Examples)	Cartridge volume (Liter)	Size Ø B x H (mm)
EBZ-DF-1-CF	1	90 x 400
EBZ-DF-5-CF	5	160 x 420
EBZ-DF-10-CF	10	220 x 510



FLUIDIC DATA

Gas composition [Vol-%]:	
Temperature [°C]:	Maximal pressure loss [mbar]:
Inlet pressure [bar(g)]:	Average flow rate [l _{N,STP} /min]:

SULPHUR DATA

THT [mg/m ³] / [ppmv]:	H ₂ S [mg/m ³] / [ppmv]:
TBM [mg/m ³] / [ppmv]:	SO ₂ [mg/m ³] / [ppmv]:
COS [mg/m ³] / [ppmv]:	Others:

Minimal time between service intervals:

